



Led flashing lights/
Wall flashing LED

MICRO-FLASH



MICRO-FLASH is the innovative led flashing light designed to make the automation of garage doors more beautiful and high tech looking

- perfect for overhead and sectional doors
- visible only when is flashing
- can be installed anywhere in minutes



APE - 550 / 1040
MICRO-FLASH
power supply 12-24V

APE - 550 / 1040.20

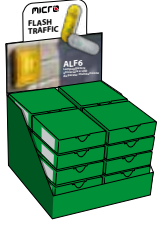

PACKAGE n°20
MICRO-FLASH
with counter box

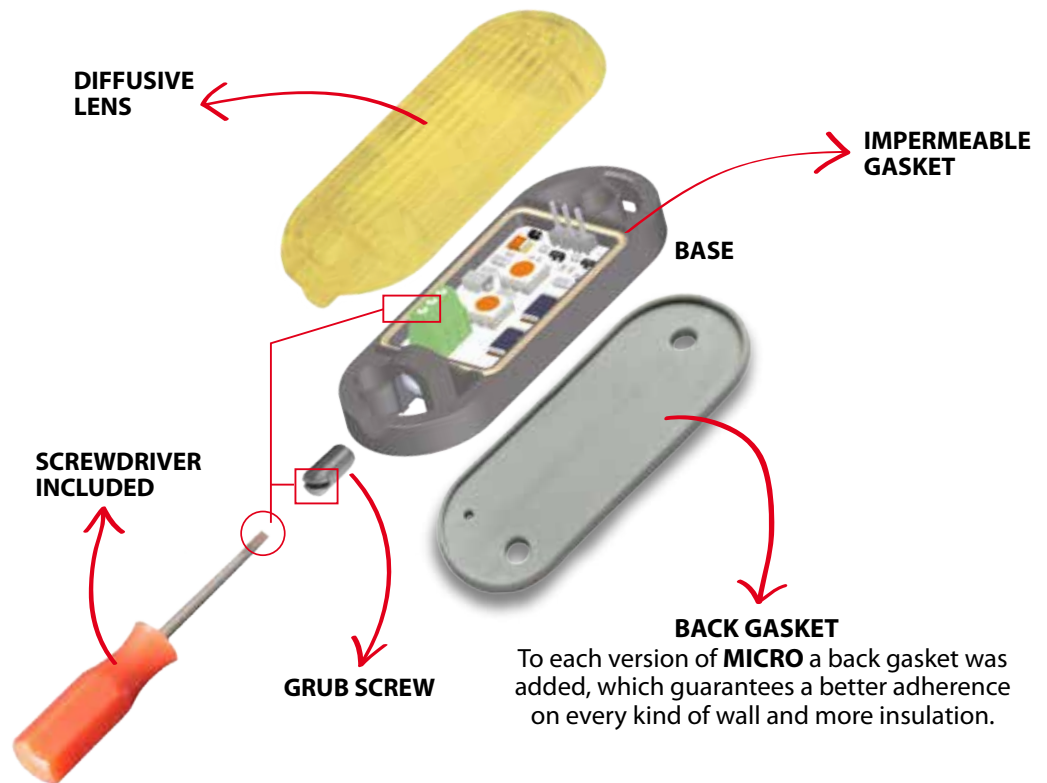

TECHNICAL SPECIFICATIONS

MICRO-FLASH allows choosing, through a jumper, 2 flashing types: steady light, flashing light

Power supply	MAX absorption (mA)	Brightness (lm)
24Vac +20% / -10%	62	45
24Vdc +/-20%	55	45
12Vdc +10% / -5%	70	40

In the early years of spread of automatic gates the cost to have them was very high. The automation was economically for the few and the flashing light, installed in evidence, in addition to its role of signaller, was used as a status symbol: large and very showy. Today the gate automation is affordable for many and the role of the flashing light has changed.

MICRO-FLASH is a small flashing light perfectly integrable in the system because of its size, but at the same time gives the maximum visibility during movement to signal the danger.

**A nice gate need a nice flashing light. Well visible...
but ONLY when it's NECESSARY.**

INNOVATIVE DESIGN

Led flashing lights/
Wall flashing LED

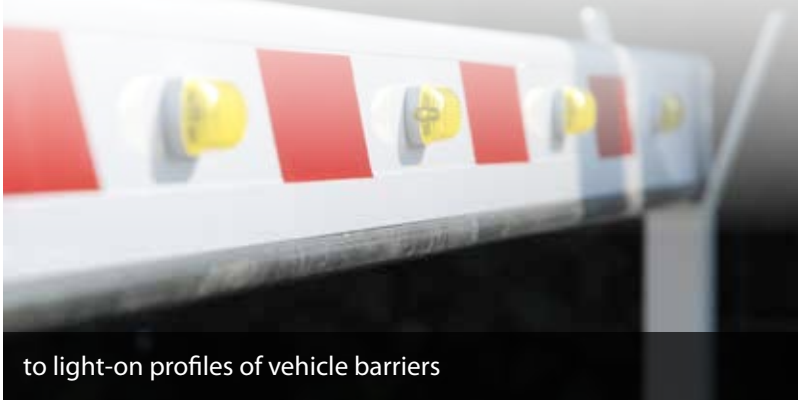
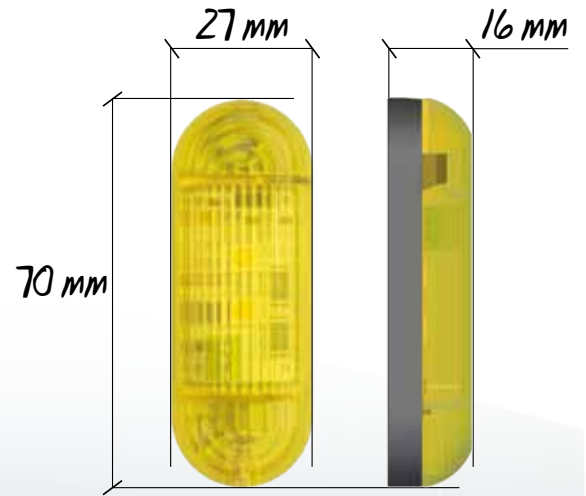
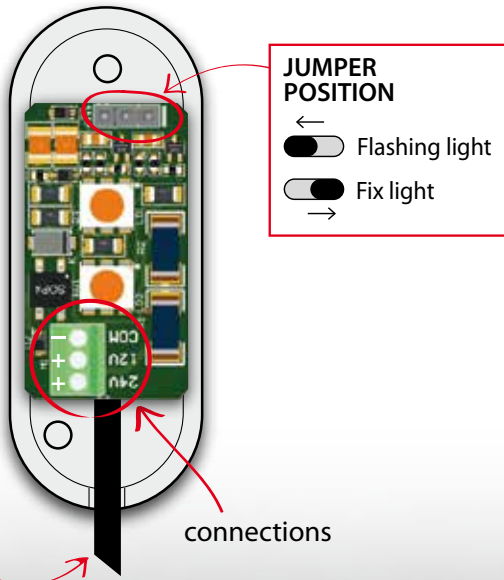

<p>APE - 550 / 1043</p>  <p>MICRO-FLASH GREEN</p>	<p>APE - 550 / 1042</p>  <p>MICRO-LUX</p>	<p>APE - 550 / 1041</p>  <p>MICRO-FLASH RED</p>
--	---	--