

**MICRO-RGB** is the ideal led signalling light to show the status of an alarm system or a door in an access control system. Thanks to its compact dimensions, it perfectly fits any fixing area, walls or pillars, without affecting the elegance of the facade. The colours of the materials used to manufacture this light perfectly match both with traditional and modern or aluminium-made fixtures.

3 pin terminal with common and 2 poles for independent connection of light control. Colours can be selected through the position of DIP-SWITCH.



#### EXAMPLE OF SELECTION



**SHINY DIFFUSED LENS**



**BASE**

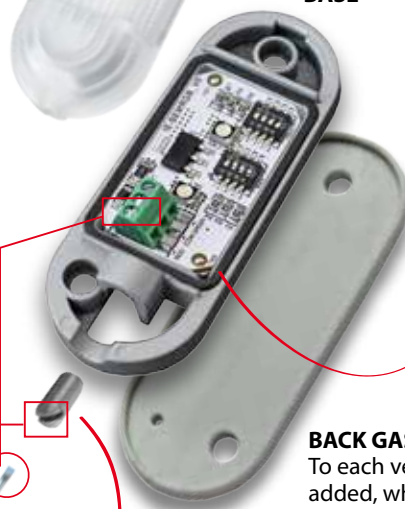

**IMPERMEABLE GASKET**

**BACK GASKET**

To each version of **MICRO** a back gasket was added, which guarantees a better adherence on every kind of wall and more insulation.

**SCREWDRIVER INCLUDED**



**GRUB SCREW**



**APE - 550 / 1038**

**MICRO-RGB**  
LED signalling light

Operating temperature  
-20°C, +60°C

#### TECHNICAL DATA

Power supply	MAX absorption (mA)	Brightness min÷max (mcd)		
		RED	GREEN	BLUE
24Vac +20% / -10%	55	180 ÷ 350	450 ÷ 850	180 ÷ 350
24Vdc +/-20%	35			
12Vdc +10% / -5%	25			

#### Table of DIP-SWITCH selection

DIP-SWITCH	COLOR SELECTION					
	Red and Green singles	IN Red double red	IN Red pilots the BLUE	IN Green pilots the BLUE	IN Red and IN Green pilot single BLUE	IN Red or IN Green double BLUE
	IN Red <input type="checkbox"/> IN Green <input type="checkbox"/>	IN Red <input type="checkbox"/> IN Green <input type="checkbox"/>	IN Red <input type="checkbox"/> IN Green <input type="checkbox"/>	IN Red <input type="checkbox"/> IN Green <input type="checkbox"/>	IN Red <input type="checkbox"/> IN Green <input type="checkbox"/>	IN Red <input type="checkbox"/> IN Green <input type="checkbox"/>
SW1-1		ON				
SW1-2		ON				
SW1-3						ON
SW1-4						
SW2-1	ON	ON		ON		
SW2-2			ON		ON	ON
SW2-3	ON	ON	ON			
SW2-4				ON	ON	ON

