

Advantages

- Very compact design
- Long range
- Integrated electronics
- Adaptable to different types of installations

As with all other Witt products, the LIGI 07 barrier has been specifically designed to operate in the harsh conditions typical of industrial gates. The super-compact, integrated design measures just 12x15mm, offering perfect protection against the humidity and vibrations typical of automatic door installations.

The LIGI 07 barrier sets new standards for the future with state-of-the-art electronics and intelligent firmware.

It is compatible with all standard control units for automation and can be used with almost all existing systems.

- For doors up to 10 m wide
- Can be installed in the door jamb with the BLANKING feature (beam cancellation)
- Extremely robust, all components are integrated into a single metal body
- Pre-drilled with front holes for direct mounting
- Available with OSE output or solid-state relay (SSR)
- Electronic self-alignment
- Integrated diagnostics
- Highly resistant to external optical interference
- Compact size: only 12x15mm

Technical specifications

Passage width	1,6 - 10 m
Operating voltage	10 - 30 Vcc
Current consumption	Transmitter: approx. 30 mA (24 Vdc) (24 Vdc) Receiver: approx. 20 mA (24 Vdc)
Power consumption	approx 1,2 W
Optical emission	modulated infrared
OSE output	Approximately 950 Hz, alternating signal, 4 V 20 mA, short-circuit protection and protected against polarity reversal
Maximum leakage current	max 30 uA
Pull-down resistance	220 ohm
Output	SSR solid state relay 100 mA, protected circuits
Intrinsic capacity	220 nF, max. 30 Vcc, max. 21 Vca, Rs on < 35 ohm
Response time	< 100ms
Reboot time	< 400 ms
Environment lighting	> 100 klux
External material	Fully resin-coated aluminium profile
Connector	6-pin M8 plug
Certification	IP67, EN60529
Operating temperature	-20°, +60°C
Storage temperature	-30°, +70°C

Wiring diagram for OSE output

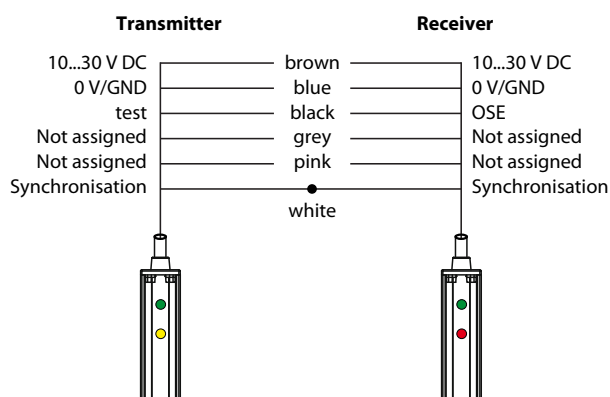

Error diagnostic indicators

Legend: ● Fixed LED
★ Flashing LED
⊗ LED off

Error diagnosis via LED indicators

	Transmitter	Performance	Receiver	
Current tension absent	⊗		⊗	Power Supply check
Reverse polarity on the receiver	★ ★ ★	LED flashing 3 times, long pause	⊗	Check the voltage at the receiver terminals
Short circuit output		LED flashing red twice, long pause	★ ★	Verify the power supply at the relay output
Failed alignment	★ ★ ★	LEDs flash 3 times, long pause	★ ★ ★	Check the synchronisation connection between the receiver and transmitter
Internal error	★ ★ ★	All LEDs are flashing	★ ★ ★	The barrier must be replaced

Caution!

Using screws larger than 4 mm in diameter may damage the electronics

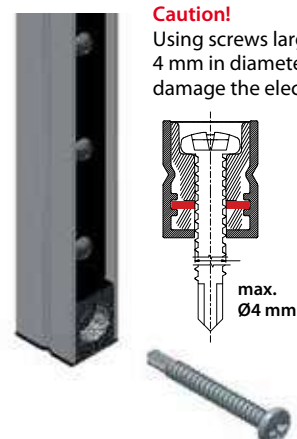

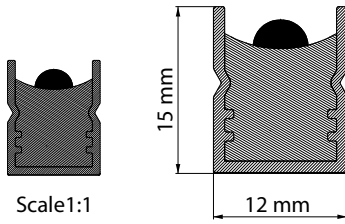

Available versions:

- OSE output with blanking function (gradual beam blanking during door downward movement)
- SSR output (solid state relay) selectable NC/NO, with blanking function

LIGI 07 can ONLY be installed on high-speed doors

Item codes

All LIGI 07 models are equipped with a 6-pin plug and two cables measuring 5 and 15 metres.

Model	Number of spokes	SF	GH	Item code with SSR output	Item code with OSE output	
-------	------------------	----	----	---------------------------	---------------------------	--

version "C"

07 - C20	23	2430	2555	WI-321003	WI-321033	
07 - C19	22	2250	2375	WI-321006	WI-321036	
07 - C18	21	2070	2195	WI-321009	WI-321039	
07 - C17	20	1890	2015	WI-321012	WI-321042	

version "A"

07 - A54	54	2430	2555	WI-320985	WI-321015	
07 - A51	51	2295	2420	WI-320988	WI-321018	
07 - A48	48	2160	2285	WI-320991	WI-321021	
07 - A46	46	2070	2195	WI-320994	WI-321024	
07 - A43	43	1935	2060	WI-320997	WI-321027	
07 - A40	40	1800	1925	WI-321000	WI-321030	

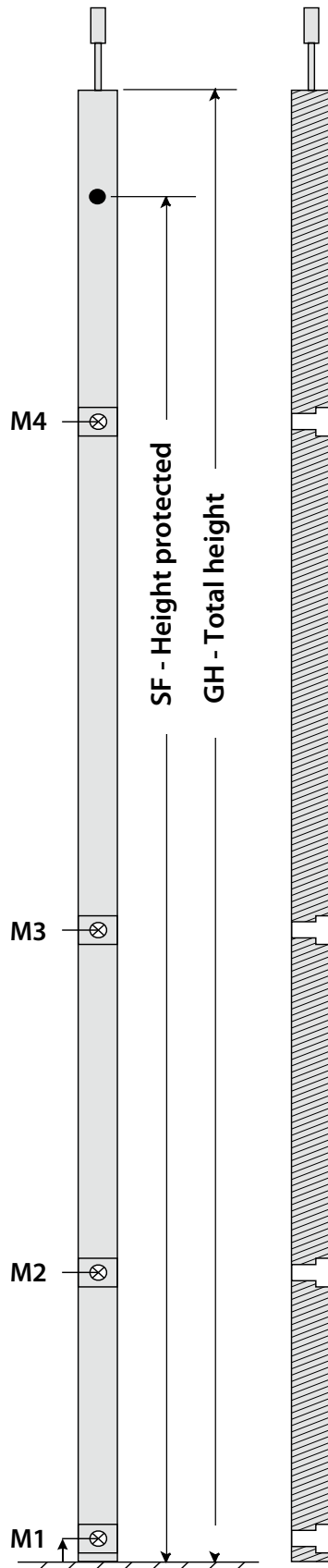

High-speed / Roll-up doors

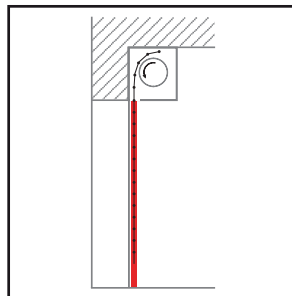

Edge protection with guide installation

Vertical folding doors

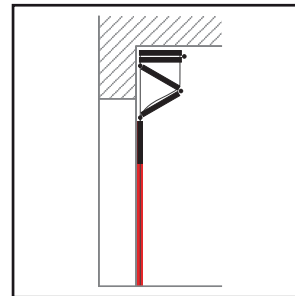

Protection during closing movement with guide installation

Sectional doors

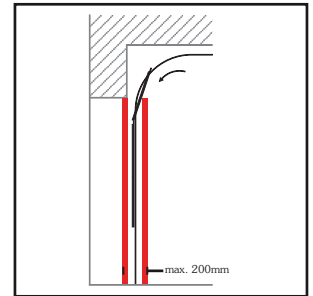

Barrier installation on both sides of the gate, with a threshold of up to 160 mm

Swing doors

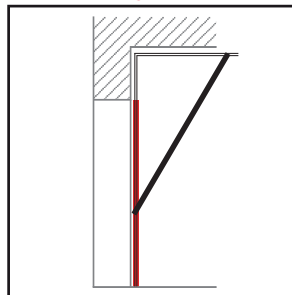

Installation on the movement plane of the end of the gate

Vertical folding doors

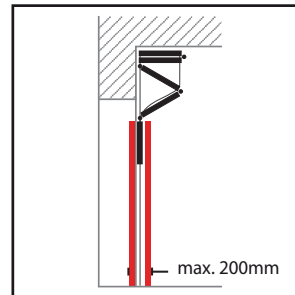

Installation on both sides of the gate when installation inside the guide is not possible

Folding doors

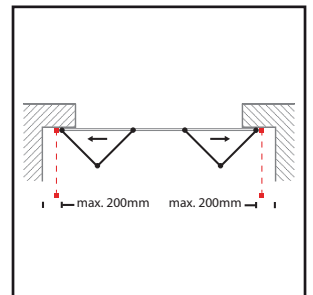

Pivot point protection